



Telaris Multifunction Installation Tester Series

ProInstall-100-EUR / ProInstall-200-EUR
ProInstall-100-D / ProInstall-200-D
ProInstall-100-CH / ProInstall-200-CH
ProInstall-100-DK

Quick Reference Guide

Limited Warranty and Limitation of Liability

Your Amprobe product will be free from defects in material and workmanship for one year from the date of purchase, unless local laws require otherwise. This warranty does not cover fuses, disposable batteries or damage from accident, neglect, misuse, alteration, contamination, or abnormal conditions of operation or handling. Resellers are not authorized to extend any other warranty on the behalf of Beha-Amprobe. To obtain service during the warranty period, return the product with proof of purchase to an authorized Beha-Amprobe Service Center or to an Beha-Amprobe dealer or distributor. See Repair Section for details. THIS WARRANTY IS YOUR ONLY REMEDY. ALL OTHER WARRANTIES - WHETHER EXPRESS, IMPLIED OR STATUTORY - INCLUDING IMPLIED WARRANTIES OF FITNESS FOR A PARTICULAR PURPOSE OR MERCHANTABILITY, ARE HEREBY DISCLAIMED. MANUFACTURER SHALL NOT BE LIABLE FOR ANY SPECIAL, INDIRECT, INCIDENTAL OR CONSEQUENTIAL DAMAGES OR LOSSES, ARISING FROM ANY CAUSE OR THEORY. Since some states or countries do not allow the exclusion or limitation of an implied warranty or of incidental or consequential damages, this limitation of liability may not apply to you.

Repair

All test tools returned for warranty or non-warranty repair or for calibration should be accompanied by the following: your name, company's name, address, telephone number, and proof of purchase. Additionally, please include a brief description of the problem or the service requested and include the test leads with the meter. Non-warranty repair or replacement charges should be remitted in the form of a check, a money order, credit card with expiration date, or a purchase order made payable to Amprobe.

In-Warranty Repairs and Replacement – All Countries

Please read the warranty statement and check your battery before requesting repair. During the warranty period any defective test tool can be returned to your Amprobe distributor for an exchange for the same or like product.

Non-Warranty Repairs and Replacement – Europe

European non-warranty units can be replaced by your Amprobe distributor for a nominal charge. Please check the "Where to Buy" section on www.amprobe.eu for a list of distributors near you.

European Correspondence Address*

Beha-Amprobe®
 Beha-Amprobe GmbH
 In den Engematten 14
 79286 Glottental, Germany
 Tel.: +49 (0) 7684 8009 - 0
www.amprobe.eu

*(Correspondence only – no repair or replacement available from this address. European customers please contact your distributor.)

V, Hz

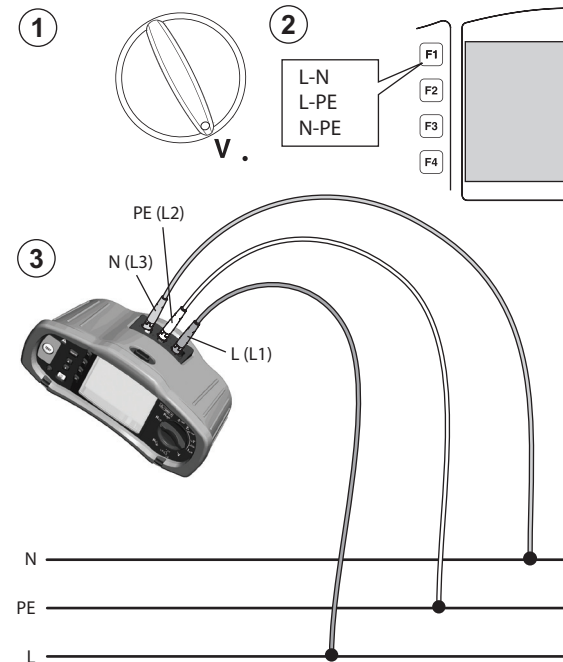

R_{ISO} Insulation · Isolement · Isolation

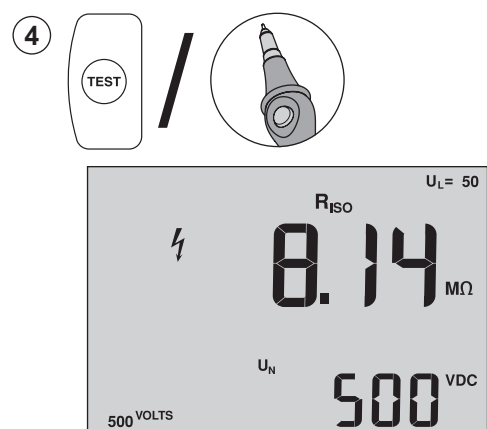
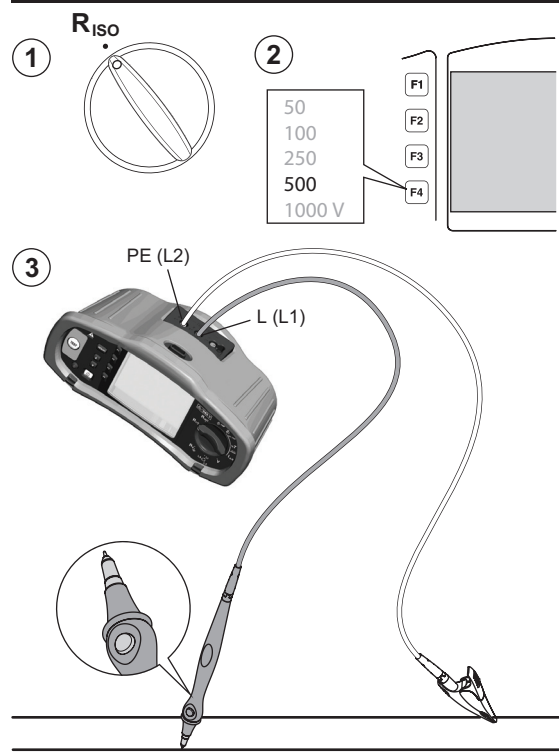

R_{LO} Continuity · Continuité · Niederohm

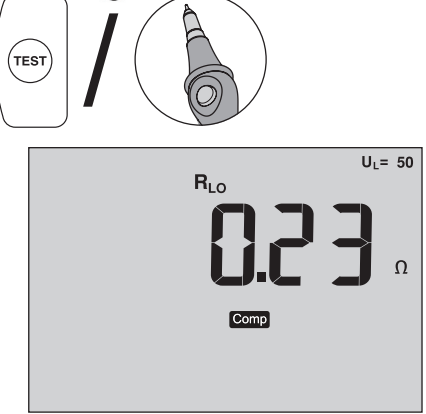
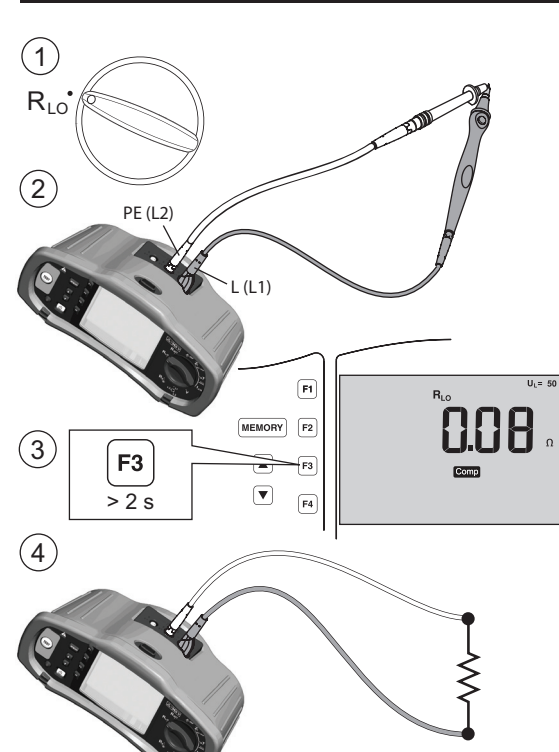

Battery

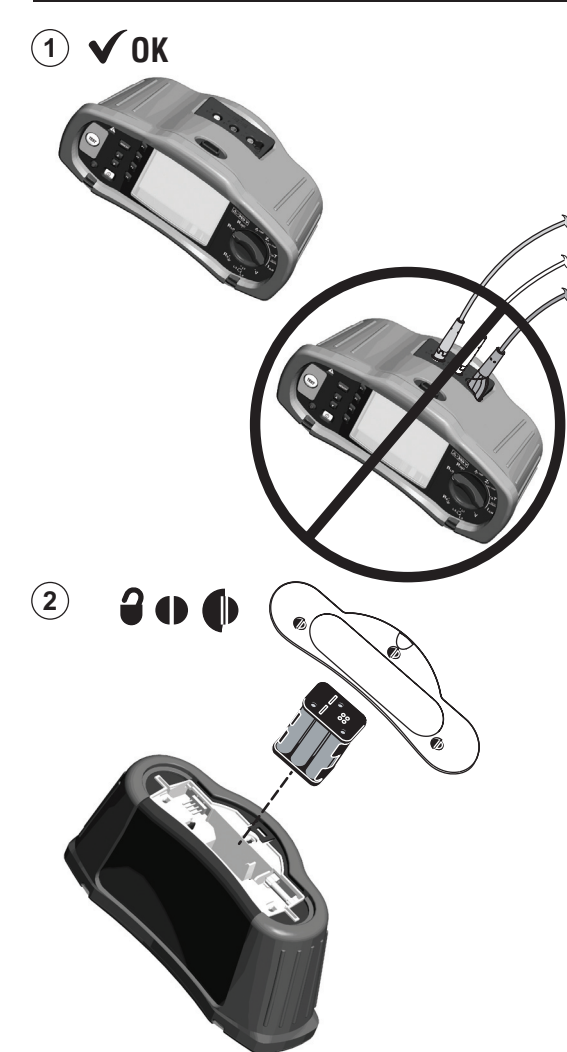

Z_L Loop · Boucle · Schleife

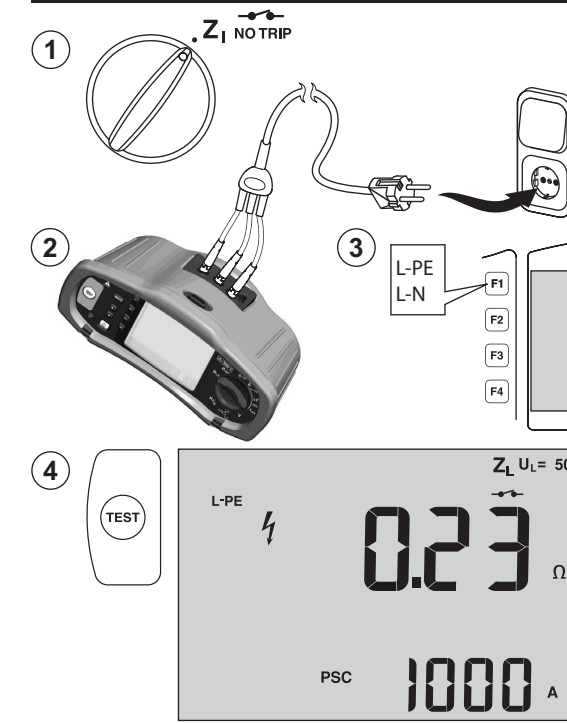

PEWA
 Messtechnik GmbH
 Weidenweg 21
 58239 Schwerte
 Tel.: 02304-96109-0
 Fax: 02304-96109-88
 E-Mail: info@pewa.de
 Homepage: www.pewa.de

Z₁ Loop · Boucle · Schleife

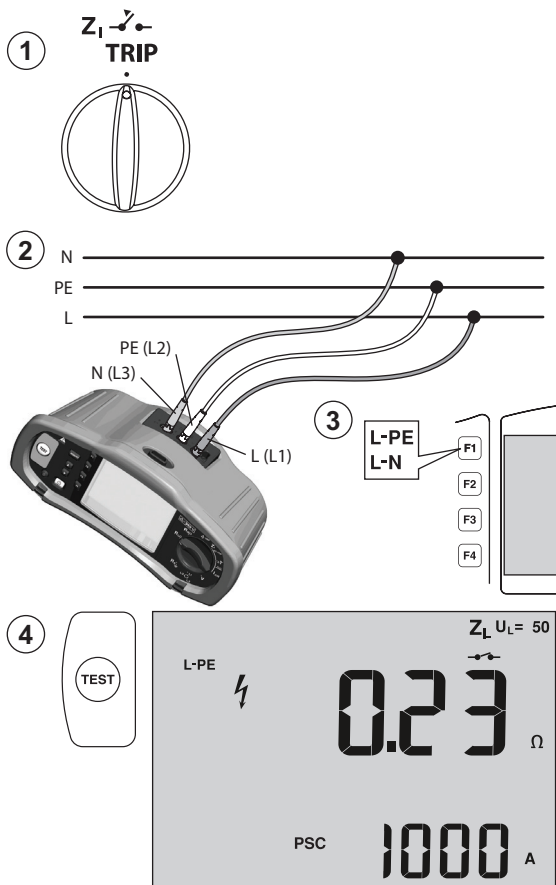

ΔT / I_{ΔN} RCD · Disjoncteur différentiel · FI

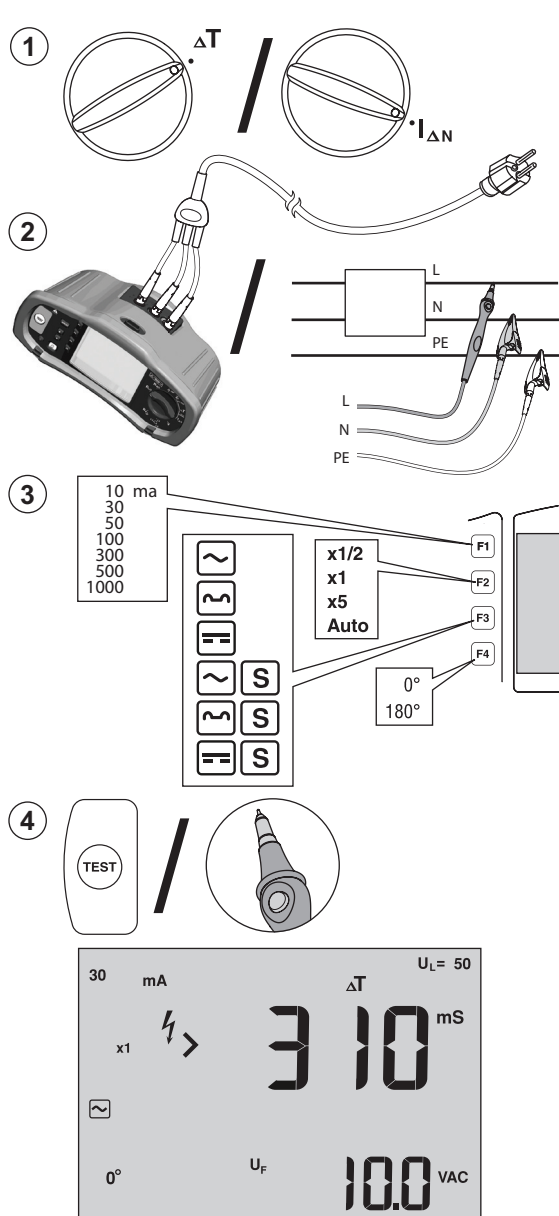

R_E Earth · Terre · Erde

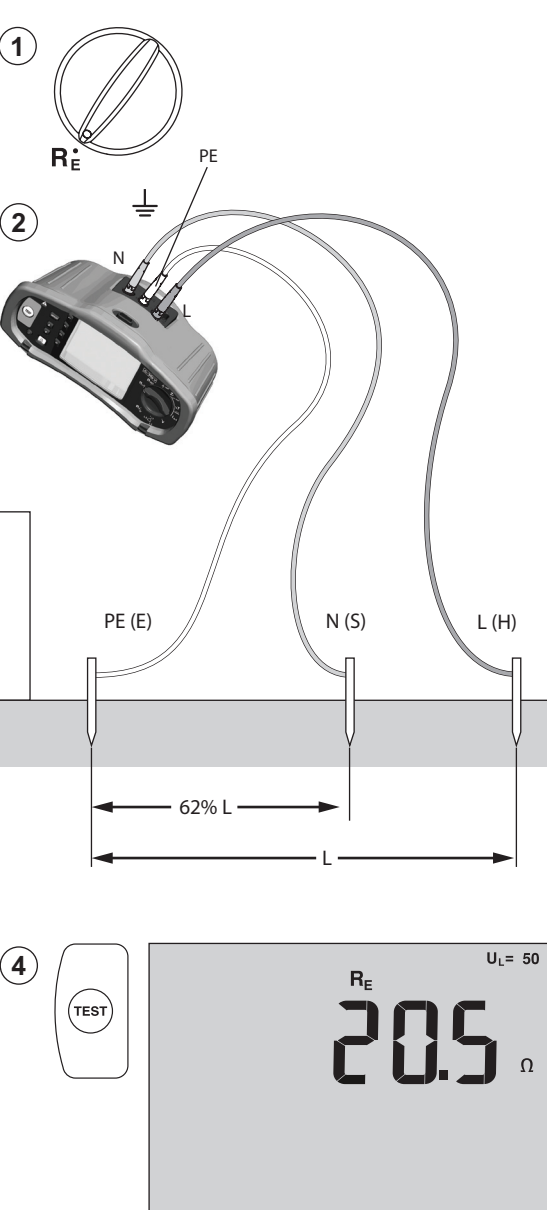

Phase rotation · Rotation de phase · Phasenfolge

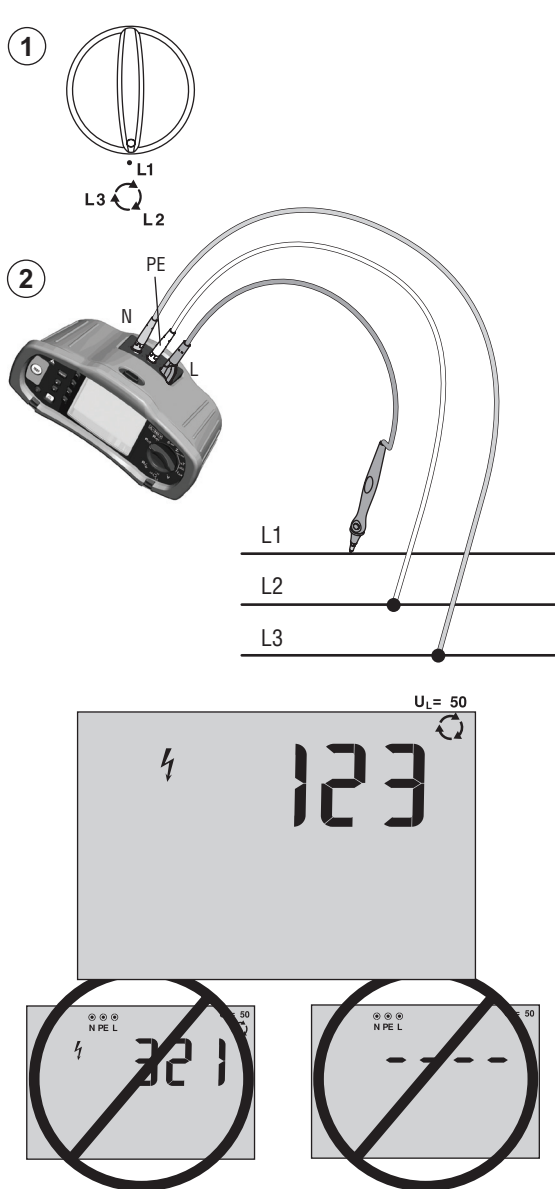

IR

