

**Model 3846**  
**Adapter, Isolated Ground BNC**  
**Female To Female**

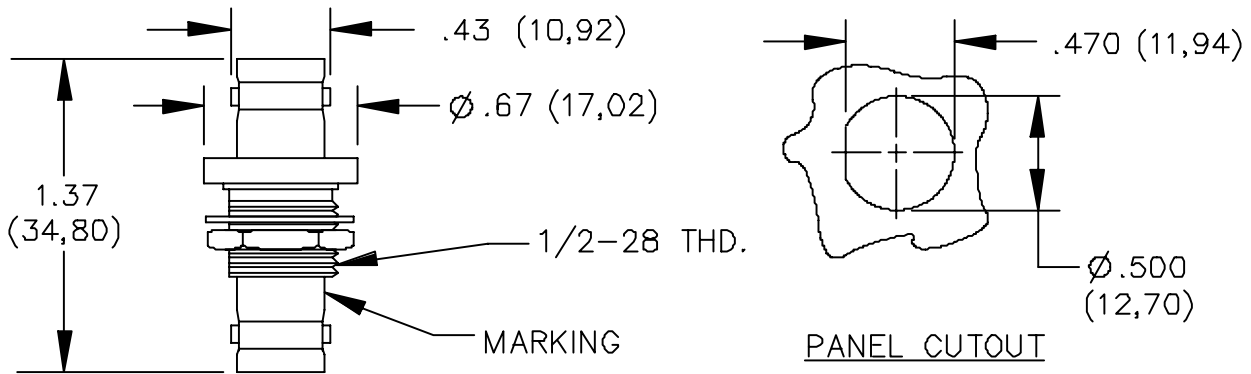

**FEATURES:**

- Mounts in panels up to .175 (4,45) thick.
- BNC shell body isolated from threaded flange.

**MATERIALS:**

Body – Brass, Tarnish Resistant Plating, Center Contact: Gold Plated Beryllium Copper

Dielectric: PTFE

Center Contact – Gold Plated

Marking: “Pomona 3846”

**RATINGS:**

Operating Voltage: Inner Conductor/Shield: 500VRMS Max.

Operating Temperature: -65°C to +165°C

Nominal Impedance: 50 Ohms

**ORDERING INFORMATION: Model 3846**

All dimensions are in inches. Tolerances (except noted): .xx = ±.02” (.51 mm), .xxx = ± .005” (.127 mm).

All specifications are to the latest revisions. Specifications are subject to change without notice.

Registered trademarks are the property of their respective companies. Made in USA