

Models 4862, 4864, 6268, 6269 Replacement Cover Screws For Phenolic and Shielded Aluminum Boxes

FEATURES:

- These screws are specifically designed for securing the covers on our phenolic, die cast aluminum and extruded aluminum boxes.
- Each screw is designed to fit a specific application.
- All are made of high quality carbon steel with zinc plating for the best corrosion resistance.

Figure 1: Model 4864, #2-32 Self-Tapping Phillips

Replaces cover screws used in all die cast aluminum size A, size B and Miniature boxes. Carbon steel with blue zinc plating.

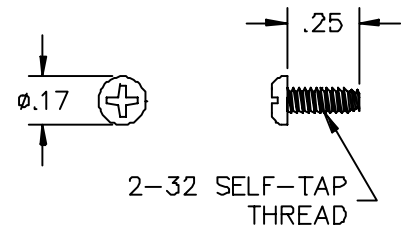

FIGURE 1 MODEL 4864

Figure 2: Model 4862, #4-40 UNC Flat Head Phillips

Replaces cover screws used in all extruded aluminum alloy size F, G & H boxes. Carbon steel with blue zinc plating.

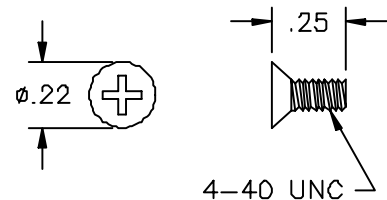

FIGURE 2 MODEL 4862

Figure 3: Model 6268, #4-40 UNC Binding Head Phillips

Replaces cover screws used in die cast aluminum alloy, size C Boxes. Carbon steel with blue zinc plating

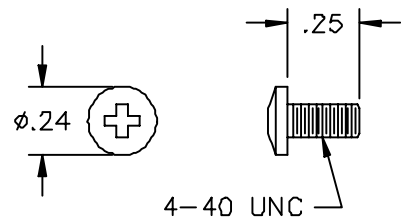

FIGURE 3 MODEL 6268

Figure 4: Model 6269, #2-56 UNC Pan Head Phillips

Replaces cover screws used in phenolic molded boxes. Carbon steel with blue zinc plating.

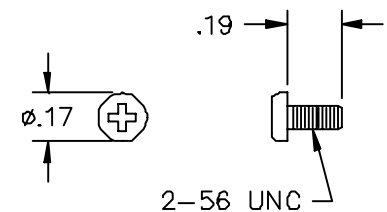

FIGURE 4 MODEL 6269

All dimensions are in inches. Tolerances (except noted): .xx = ±.02" (.51 mm), .xxx = ±.005" (.127 mm).
All specifications are to the latest revisions. Specifications are subject to change without notice.
Registered trademarks are the property of their respective companies. Made in USA