

## Model 5144 & 6235 SMD Test Probe

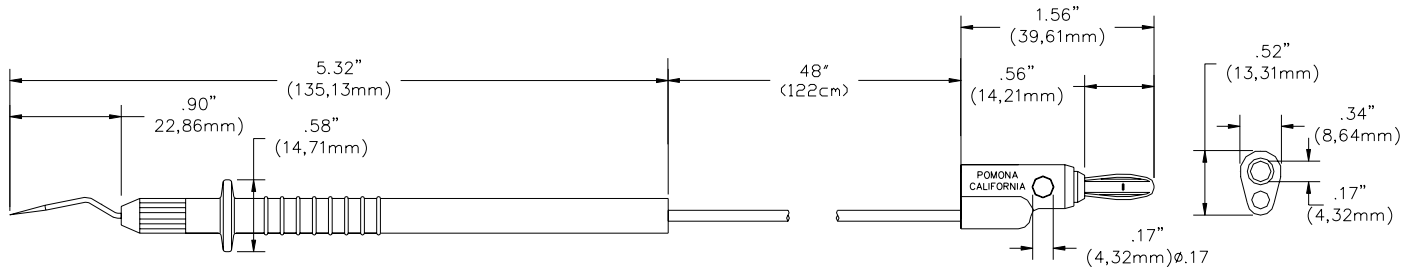

### FEATURES:

- ✓ The microtip is specially designed to probe SMD contacts.
- ✓ It features a stainless steel needle tip that is flexible to help prevent damage to the SMD leads.
- ✓ The microtip is curved to aid in probing of hard to reach areas.

### MATERIALS:

#### Test Probe

- Removable Micro Tip – Stainless steel.
- Removable Chuck – Brass per QQ-B-626, Alloy 360, ½ Hard.
- Finish: Chuck – Nickel plated per QQ-N-290, Class 2, 200/300 microinches.
- Insulation: Chuck Nut and Probe Body – Nylon. Color matches color of wire.
- Wire: 20 AWG, stranding 41 x 36, tinned copper, PVC insulated, 2.21 (.087) O.D.

#### Stacking Banana Plug

- Spring – Beryllium Copper per QQ-C-533, Alloy 172, Cond. HT.
- Plug Body – Brass per QQ-B-626, Alloy 360, ½ Hard.
- Finish: Nickel plated per QQ-N-290, Class 2, 200/300 microinches.
- Insulation: Polypropylene, molded to plug body and wire. Color matches color of wire.

### RATINGS:

Operating Voltage: Hands free usage in controlled voltage environments: 1200 Vrms maximum. *For CE compliance: not intended for hand-held use at voltages above 33 Vrms/70 Vdc.*

Current: 5 Amps

Operating Temperature: +131°F (+55°C) Max.

### ORDERING INFORMATION:

- Model: 5144-48-0 48" (122cm) black test lead
- Model: 5144-48-2 48" (122cm) red test lead
- Model: 6235 Set contains one each of model 5144-48-0 and 5144-48-2.

*For custom lengths, send email request to:  
[custom@pomonatest.com](mailto:custom@pomonatest.com).*

### Replaceable Tips:

- Model 5688: Standard
- Model 4172: Stainless-Steel Sharp Point
- Model 5133: SMD Microtip, Stainless-Steel Sharp Point
- Model 4988: Needle Stainless-Steel Sharp Point
- Model 6364: Set of tips

All dimensions are in inches. Tolerances (except noted): .xx = ±.02" (.51 mm), .xxx = ±.005" (.127 mm).  
All specifications are to the latest revisions. Specifications are subject to change without notice.  
Registered trademarks are the property of their respective companies.

Sales: 800-490-2361 Fax: 888-403-3360 Technical Support: 800-241-2060 ([technicalsupport@pomonatest.com](mailto:technicalsupport@pomonatest.com))  
For "Where to Buy" information, visit the Pomona web site at [www.pomonaelectronics.com](http://www.pomonaelectronics.com)