

Model 5178
Female To Female
Triaxial Bulkhead Feed Thru

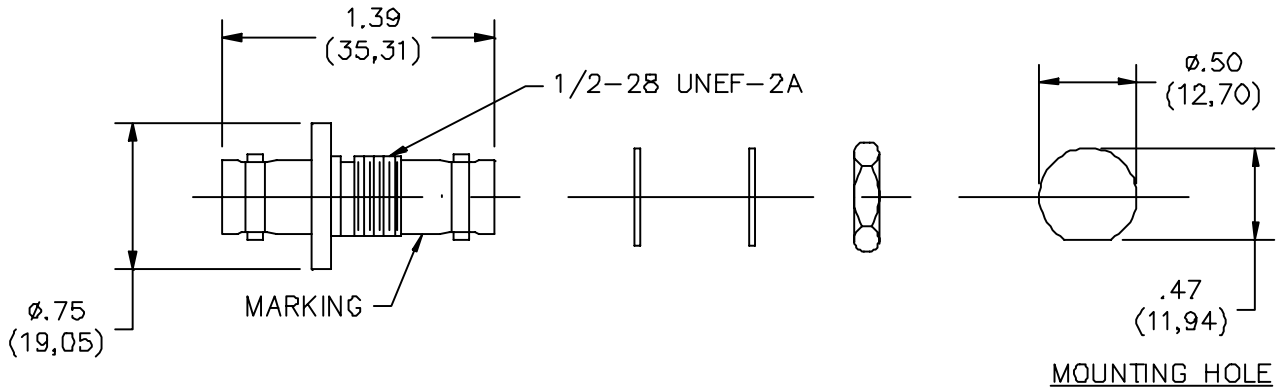

MATERIALS:

Body/Fittings: Brass, Tarnish Resistant Plating, Alloy 360, 1/2 Hard
Center Contact: Gold Plated Beryllium Copper
Dielectric: PTFE
Gasket: Silicon Rubber per ZZ-R-765, Class II, Grade 50
Marking: "POMONA 5178"

RATINGS:

Operating Voltage: 500 VRMS

ORDERING INFORMATION: Model 5178

All dimensions are in inches. Tolerances (except noted): .xx = ±.02" (.51 mm), .xxx = ± .005" (.127 mm).
All specifications are to the latest revisions. Specifications are subject to change without notice.
Registered trademarks are the property of their respective companies.

Made in USA