

## Models 72914

### 4mm Safety Banana Jack to 2mm Banana Plug Adapter

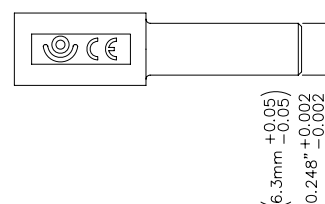
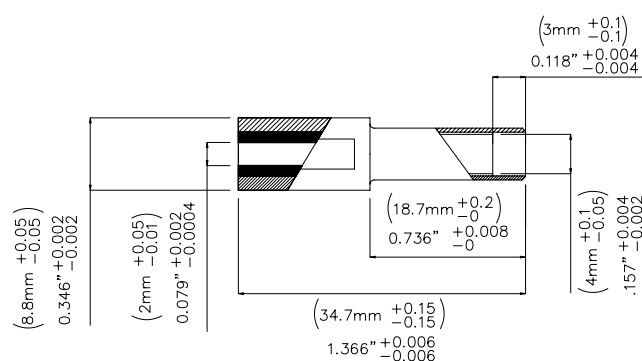

## Features

- Provides a quick and easy conversion from a 4mm banana plug to a 2mm.
- Allows 4mm banana plugs/ patch cords to connect to 2mm banana jacks or binding posts

## Materials

- Jack: Nickel plated brass
- Insulation: Polyamide

## Ordering Information

Model 72914- Color Sold 10 per package  
 Colors: -0 (Black) and -2 (Red)

Model: 72914-02 contains 1 black and 1 red

## Specifications

|                |                  |
|----------------|------------------|
| Max Current    | 36A max          |
| Max Voltage    | 33 V AC/ 70 V DC |
| Max Resistance | Less than 5 mΩ   |

**Rating:** *hands free testing* in controlled environment:  
 70Vrms max. For CE compliance: Not intended for hand-held use at voltages above 33Vrms/70Vdc

**USA:** Sales: 800-490-2361 Technical Support: 800-241-2060 Fax: 888-403-3360

**Europe:** 31-(0) 40 2675 150 **International:** 425-446-5500  
**e-mail:** [technicalsupport@pomona-test.com](mailto:technicalsupport@pomona-test.com)

**Where to Buy:** [www.pomonaelectronics.com](http://www.pomonaelectronics.com)

All dimensions are in inches. Tolerances (except noted): .xx =  $\pm 0.02$ " (.51 mm),  
 .xxx =  $\pm 0.005$ " (.127 mm). All specifications are to the latest revisions.  
 Specifications are subject to change without notice. Registered trademarks  
 are the property of their respective companies.