

### ACCESSORIES

**PROBE EPW:** probe with sharp tip for penetration

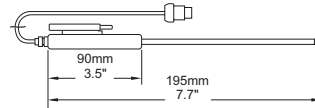

**PROBE ELW:** probe for general use and liquids

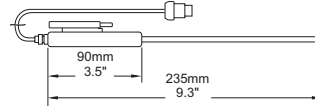

**PROBE ECW:** probe for air and gas

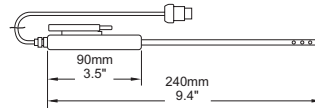

**PROBE EMW:** surface probe

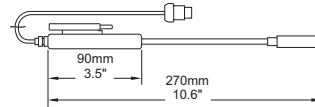

### WARRANTY

These meters are warranted for two years against defects in workmanship and materials when used for their intended purpose and maintained according to instructions. The probes are warranted for a period of six months. This warranty is limited to repair or replacement free of charge. Damages due to accident, misuse, tampering or lack of prescribed maintenance are not covered. If service is required, contact the dealer from whom you purchased the instrument. If under warranty, report the model number, date of purchase, serial number and the nature of the failure. If the repair is not covered by the warranty, you will be notified of the charges incurred. If the instrument is to be returned to Hanna Instruments, first obtain a Returned Goods Authorization Number from the Customer Service department and then send it with shipment costs prepaid. When shipping any instrument, make sure it is properly packaged for complete protection.

### SUGGESTIONS FOR USERS

Before using this product, make sure that it is entirely suitable for the environment in which it is used. Operation of this instrument in residential area could cause unacceptable interferences to radio and TV equipments, requiring the operator to take all necessary steps to correct interferences. Any variation introduced by the user to the supplied equipment may degrade the instrument's EMC performance. To avoid electrical shock, do not use this instrument when voltages at the measurement surface exceed 24 Vac or 60 Vdc. To avoid damages or burns, do not perform any measurement in microwave ovens.

## Instruction Manual

# HI 149-00 • HI 149-01

## Remote Probe Thermometer

# Foodcare

ISTI 149R2  
06/05



**PEWA**  
Messtechnik GmbH

Weidenweg 21  
58239 Schwerte

Tel.: 02304-96109-0  
Fax: 02304-96109-88  
E-Mail: [info@pewa.de](mailto:info@pewa.de)  
Homepage : [www.pewa.de](http://www.pewa.de)

**HI 149** is a portable K-type thermocouple thermometer for routine checks in the food industry.

Thanks to the user-replaceable probe, **HI 149** can be used in a wide range of applications.

You have a choice of four probes, specifically manufactured to measure the temperature of liquids, air, surface, solids and semi-solids.

Two models are available for measurement in degrees Celsius (**HI 149-00**) and Fahrenheit (**HI 149-01**).

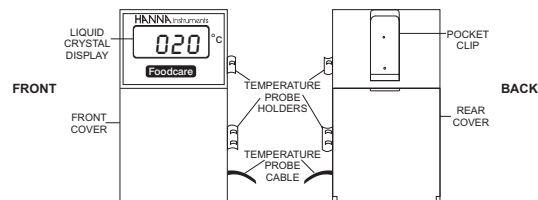

### **OPERATION**

- Connect one of the four probes (see accessories) by opening the rear cover and inserting the 3-pin connector.
- To switch the **HI 149** on, open the front cover as indicated in the picture, and slide the ON/OFF switch to the "ON" position.
- The temperature will be displayed in either °C or °F, depending on model.

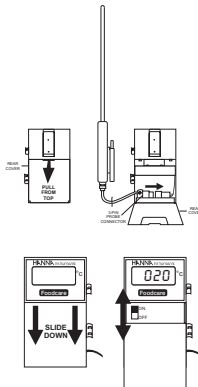

- To change the probe, open the rear cover of the unit and release the probe connector prior to inserting the new probe.
- When not in use, switch the **HI 149** off.
- Variations in readings or fading display can indicate weak batteries.

### **BATTERY REPLACEMENT**

When the **HI149** can not be switched on or the display fades, pull out the rear cover, remove the battery cover and replace all three batteries, while paying attention to their polarity.

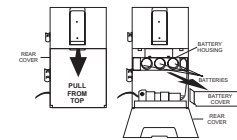

Batteries should only be replaced in a safe area and using the battery type specified in this instruction manual.

### **SPECIFICATIONS**

	<b>HI 149-00 (°C)</b>	<b>HI 149-01 (°F)</b>
<b>Range</b>	-40 to 300°C	-40 to 572°F
<b>Resolution</b>	1°C	1°F
<b>Accuracy</b>	±2°C	±4°F
<b>Typical EMC Dev.</b>	±2°C	±4°F
<b>Probe</b>	Interchangeable, stainless steel, with 1 m (3.3') cable	
<b>Battery Type</b>	3 x 1.5V	
<b>Battery Life</b>	Approx. 700 hours of continuous use	
<b>Environment</b>	0 to 50°C (32 to 122°F); RH max 95%	
<b>Dimensions</b>	106 x 68 x 21 mm (4.2x2.7x0.8")	
<b>Weight</b>	80 g (2.8 oz.)	