

## Model 72982 SMB STRAIGHT PLUG CRIMP, RG179, 196



Model 72982 SMB STRAIGHT PLUG CRIMP, RG179, 196

Snap-on coupling and small size for fast connect and disconnect.

### Features

- DC - 2 GHz bandwidth.
- Meets MIL-C-39012, IEC 60169-1Q, BS9210N0007, NFC93650, CECC 22130.
- Small size and durability for RF coaxial applications.
- Precision machined and gold-plated for low loss.

### Materials

- Body is machined brass with gold plating.
- Center contacts – Plug is gold plated brass and Jack is gold plated beryllium copper.
- High quality PTFE insulators.
- Crimp Ferrules are nickel plated copper.
- Silicone rubber gaskets.

### Ordering Information

Model: 72982

Description: SMB STRAIGHT PLUG CRIMP, RG179, 196

**USA:** Sales: 800-490-2361

Technical Support: [technicalsupport@pomonaest.com](mailto:technicalsupport@pomonaest.com)

Fax: 425-446-5844

**Europe:** 31-(0) 40 2675 150 **International:** 425-446-5500

**Where to Buy:** [www.pomonaelectronics.com](http://www.pomonaelectronics.com)

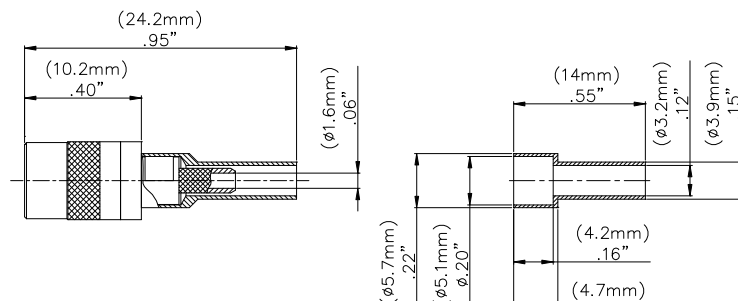

### Specifications

|                                   |                                    |
|-----------------------------------|------------------------------------|
| Impedance                         | 75 Ω                               |
| Frequency Range                   | DC - 2 GHz                         |
| VSWR                              | 1.3 max.                           |
| Working Voltage                   | 250 Vrms max.                      |
| Dielectric withstand voltage      | 750 Vrms                           |
| Center / Outer contact resistance | 6 / 1 mΩ                           |
| Number of insertions              | 500 cycles min.                    |
| Insulation resistance             | 1,000 MΩ min.                      |
| Temperature Range                 | -65° C to 165° C, -85° F to 329° F |

All dimensions are in inches. Tolerances (except noted): .xx = ±.02" (.51 mm), .xxx = ±.005" (.127 mm). All specifications are to the latest revisions. Specifications are subject to change without notice. Registered trademarks are the property of their respective companies.  
D2003422 REV 001

# Model 72982 SMB STRAIGHT PLUG CRIMP, RG179, 196

## Cable Types and Crimp Die Information

| Connector Model # | Cable Groups | Crimp Die Cavity Size for Outer Ferrule |
|-------------------|--------------|---|
| 72982             | RG179, 196   | .128 (3.3)                              |

## Cable Assembly Instructions

1. CUT CABLE END EVENLY AND PERPENDICULAR

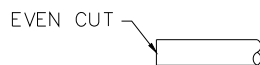

2. SLIDE OUTER FERRULE OVER CABLE END.

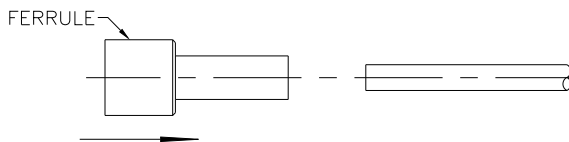

3. STRIP CABLE JACKET, BRAID, AND DIELECTRIC TO SPECIFICATION LENGTHS.

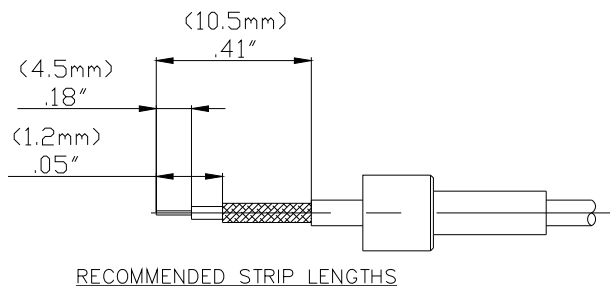

4. FLARE BRAID END SLIGHTLY.

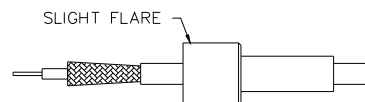

5. SLIDE CONNECTOR BODY OVER CENTER CONDUCTOR.

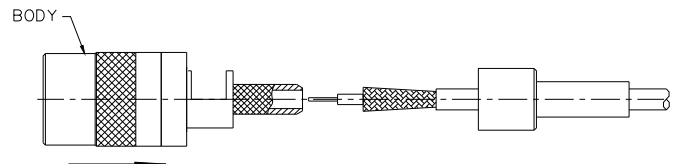

6. SLIDE OUTER FERRULE OVER BRAID AND UP AGAINST BODY ASSEMBLY.

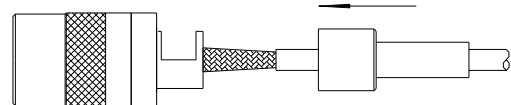

7. CRIMP OUTER FERRULE WITH APPROPRIATE CRIMP TOOL.

